

THE JD AIR PARTS ROLL TRIM KNOB INCLUDES:
CNC MACHINED ALUMINIUM TRIM KNOB,
STEEL ATTACH LUG AND ALL MOUNTING HARDWARE

INSTALLATION:

-IF BEING INSTALLED IN A NEW AIRCRAFT
FIRST DRILL HOLE IN TRIM SHAFT PER AIRCRAFT
PLANS.

-INSERT THE ATTACH LUG INTO AIRCRAFT
TRIM SHAFT.

-INSTALL BOLT AND NUT AS SHOWN.
THE NUT DOES NOT NEED TO BE TIGHT
& WASHERS ARE NOT NEEDED.

-INSTALL THE TRIM KNOB AND ENSURE
THE BOLT HEAD AND NUT REST INTO THE
TRIM KNOB SLOT.

-INSTALL BUTTON HEAD BOLT THROUGH KNOB &
INTO LUG. ENSURE THE KNOB BECOMES COMPLETELY
SECURE AS THE BOLT BECOMES TIGHT.

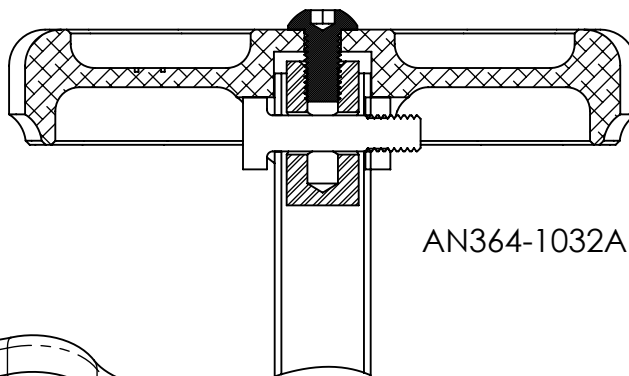
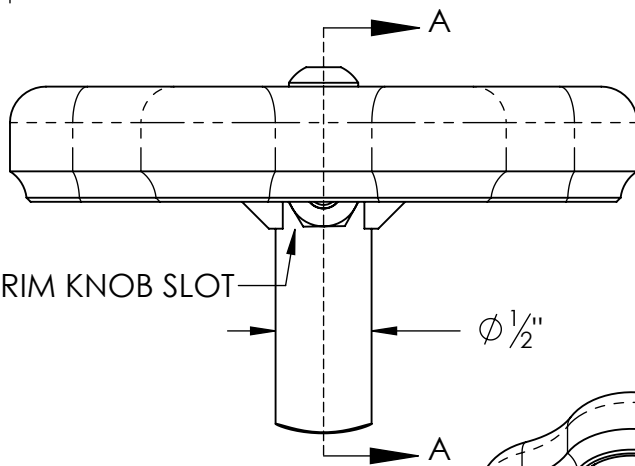
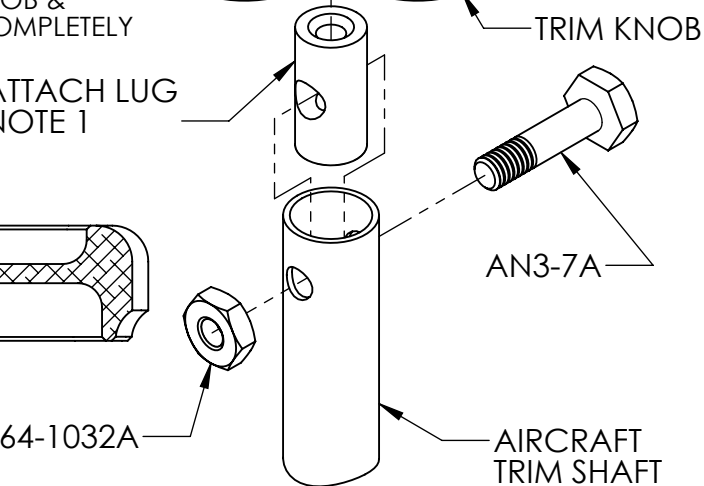
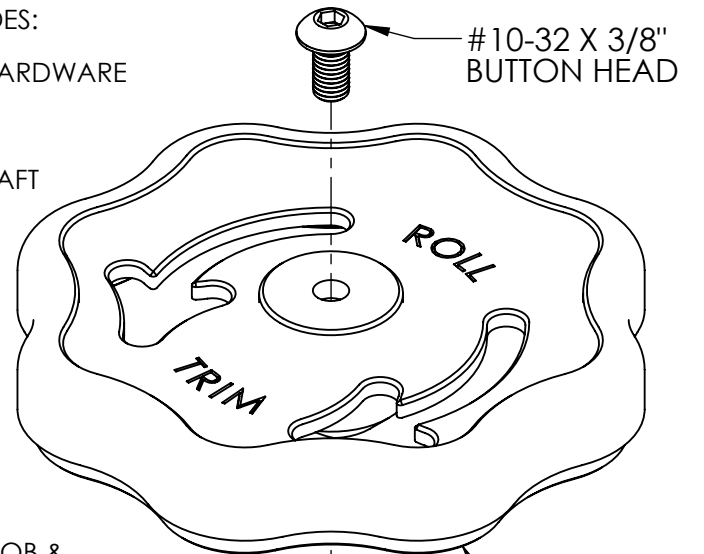

SECTION A-A

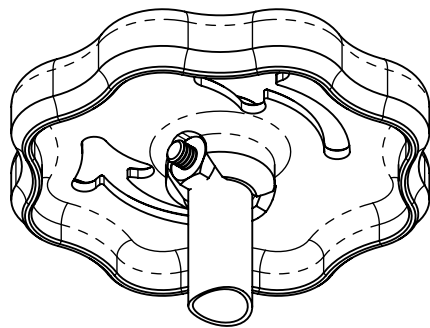

NOTE 1.
ATTACH LUG MOUNTING SYSTEM IS
DESIGNED "LOOSE" TO ACCOMMODATE
DISCREPANCIES IN THE BUILDER
DRILLED HOLE.

UNLESS OTHERWISE SPECIFIED: DIMENSIONS ARE IN INCHES	SIZE	Roll Trim Knob Assy.	REV
	A	FILE NAME: Roll Trim Assy 1	
ASSEMBLY METHOD:	SCALE: 1:1	LAST SAVED DATE: 12/12/2011	SHEET 1 OF 1